

Open up your horizons

with an ASS 39 PD.NI panoramic sliding door from Schueco



Exceptional quality, exceptional value



The Schueco ASS 39 PD.NI provides the clearest view



A flush threshold allows easy access

A fresh choice

Schueco is a new name in Australia, but we've actually had more than sixty years' experience of designing aluminium door and window systems for homes all over the world.

The Schueco ASS 39 PD.NI is a product of that experience. It's an uninsulated panoramic sliding door with a frame that is completely concealed on all four sides, allowing you to enjoy the clearest possible views.

Manually operated, its quality is unbeatable, its sliding action is always smooth and in terms of value for money, it's in a class of its own.

Innovative design

The Schueco ASS 39 PD.NI includes a track whose rollers are integrated into the sill profile, enabling the threshold to be completely flush. Result? Minimal danger of tripping and a seamless transition between indoor and outdoor living.

Another innovation is a removable roller profile to facilitate cleaning. And there's a whole range of colours and finishes to ensure that the door blends perfectly with the décor of your home.



Concealed outer frames and slim profiles add style and elegance to any home



Unique 90° free-standing corner opens up new design possibilities

Designed to last

Every aspect of the Schueco ASS 39 PD.NI reflects the care taken over its design. An integrated retaining catch and a robust locking mechanism ensure that security is never an issue.

There is also a 90° free-standing corner opening option that delivers maximum freedom of movement with a new level of style.

If you're looking for total quality in both design and performance, Schueco is the name that can deliver.

A door that meets all design needs



Wide range of opening configurations provides maximum choice

Real flexibility

The Schueco ASS 39 PD.NI can accommodate very wide openings. Its sashes can be 3.5 m high floor-to-ceiling, 2.3 m wide and up to 300 kg in weight.

Depending upon the number of sashes (up to a maximum of six), it can be configured to run on double or triple tracks, subject to wind design pressures.

There is a choice of glass thicknesses (up to 32 mm).

The aluminium profiles are slender but strong and to ensure maximum light penetration, the central meeting stile is only 37.5 mm wide.

Experience counts

The clean, contemporary lines of the Schueco ASS 39 PD.NI make it ideal for inclusion in many different types of property.

And Schueco's unrivalled experience in the design and supply of aluminium systems for the whole building envelope makes it a door that can be specified with complete confidence.

German engineering perfected for Australia

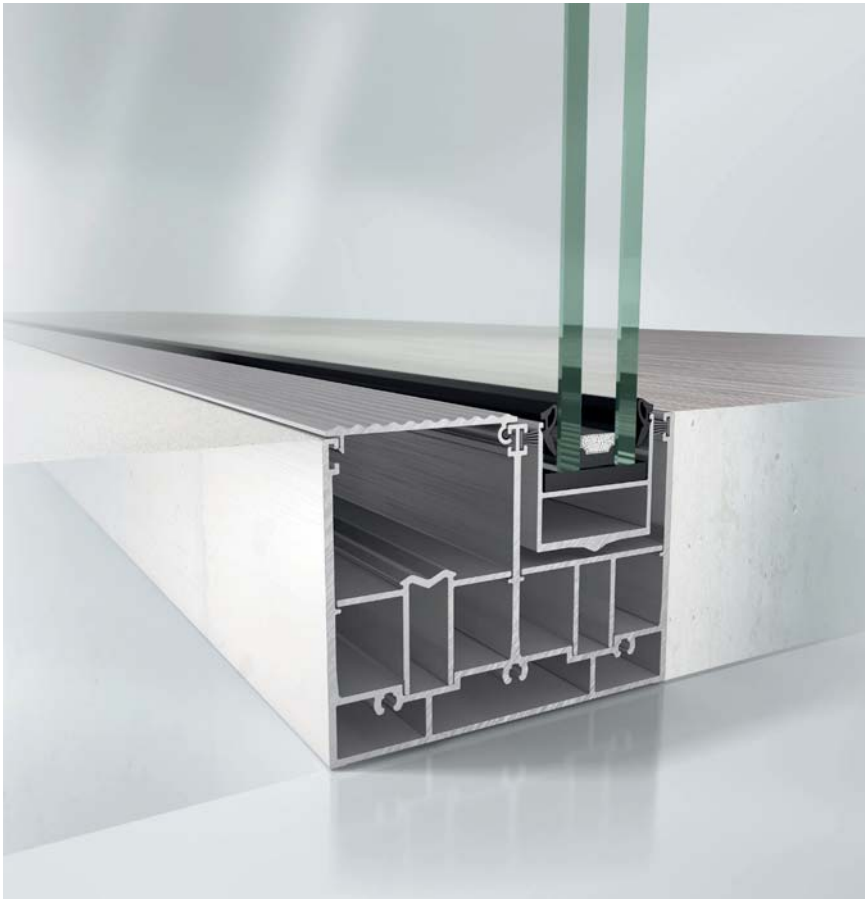

Precision engineering ensures trouble-free performance

Built to last

The Schueco ASS 39 PD.NI isn't simply a beautiful door, it's a fine piece of German engineering too. Which means that it's going to go on adding value year in, year out.

Its superior quality is immediately discernible from the rigidity of its profiles and the lack of flexing when the door is opened and closed.

Yet it is also highly affordable, meaning that for the first time for many years, designers, contractors and homeowners in Australia have a real choice when specifying a sliding-door system.

Find out more

For more information about Schueco's panoramic door range including the ASS 39 PD.NI or for details of any other Schueco door, window or façade system, visit www.schueco.com.au or call 1800 258 646 today. We'll be pleased to help.

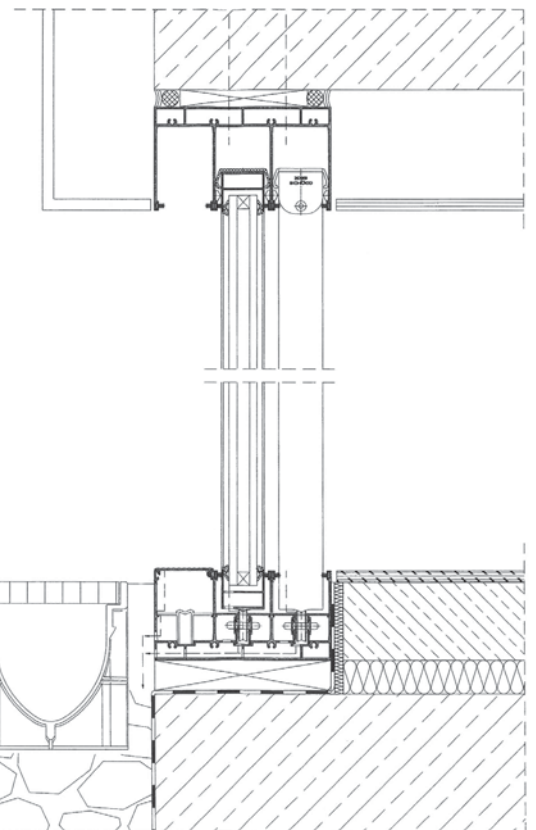

Integral drainage and removable roller track for easy cleaning

Schueco ASS 39 PD.NI



Product benefits

- Manual operating retaining catch elegantly integrated in the centre of the interlock profile
- Large selection of opening types based on multi-track outer frames
- 90 degree clear corner opening option further adding to the design flexibility
- Flyscreen option also available
- Concealed outer frame provides maximum transparency and light penetration
- Door panel can be single or double up to 32mm
- Door panel weights up to 300kg
- Innovative guide rail system can be easily removed, maintained or replaced
- Rollers can be replaced without dismantling the heavy sliding panels.



Technical data

Value

Thermal insulation	non-insulation
Basic depth of vent frame	39 mm
Vent size (HxW)	3,500 x 2,300 mm
Vent weight	300 kg
Number of tracks	2 - 3

Schueco ASS 39 PD.NI

Customer Enquiry Form

Please take a moment to provide us with some important information so that we can assist you in tailoring the Schueco ASS 39 PD.NI sliding door to your specific needs. Thank you.

Your contact details:		
Name	_____	
Phone	_____	
Email	_____	
Where is your home located?		
Is the door for a new-build or renovation project?	<input type="checkbox"/> New-build	<input type="checkbox"/> Renovation
Who is your architect/builder?		
Name	_____	
Phone	_____	
Email	_____	
Can we contact them on your behalf?	<input type="checkbox"/> Yes	<input type="checkbox"/> No
Do you have plans/drawings/window schedule?	<input type="checkbox"/> Yes (please provide)	<input type="checkbox"/> No
What are the measurements of the opening?	Width:	Height:
Please indicate which of the opening options overleaf is most suitable?		
<input type="checkbox"/> 1A <input type="checkbox"/> 1B <input type="checkbox"/> 1D <input type="checkbox"/> 2A <input type="checkbox"/> 2A/1 <input type="checkbox"/> 2B <input type="checkbox"/> 2C <input type="checkbox"/> 2D <input type="checkbox"/> 2D/1 <input type="checkbox"/> 3E <input type="checkbox"/> 3E/1 <input type="checkbox"/> 3F		
What is your preferred colour for the frame?		
Does the door need to be key lockable?	<input type="checkbox"/> Yes	<input type="checkbox"/> No
What is your preferred glazing?	<input type="checkbox"/> Single	<input type="checkbox"/> Double
Other comments:		

Schueco ASS 39 PD.NI Opening Options

Single-track design

Type 1A

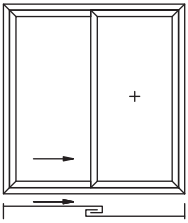

Type 1B

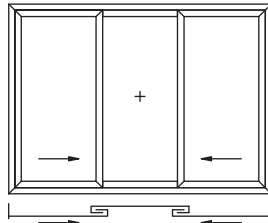

Type 1D

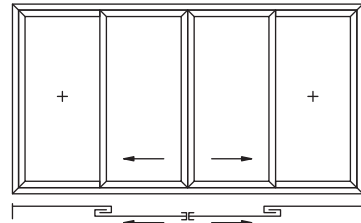

Double-track design

Type 2A

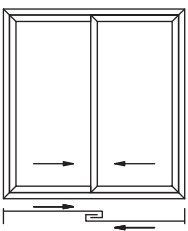

Type 2A/1

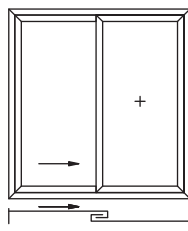

Type 2B

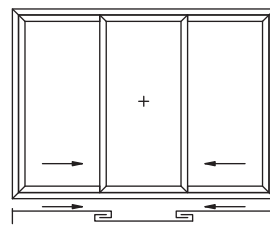

Type 2C

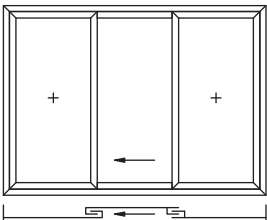

Type 2D

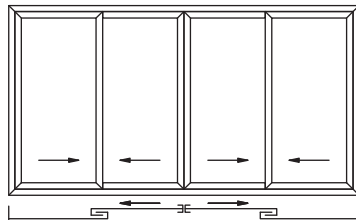

Type 2D/1

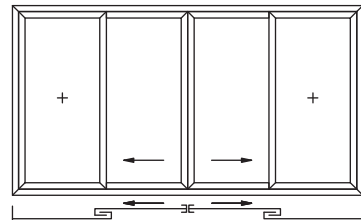

Triple-track design

Type 3E

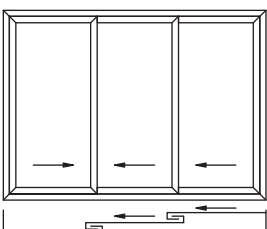

Type 3E/1

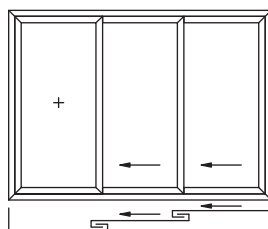

Type 3F

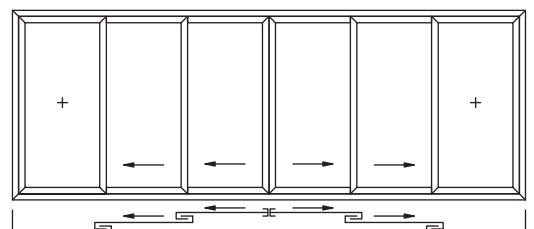

Schueco ASS 39 PD.NI Panoramic Sliding Door System



Schueco's ASS 39 PD.NI non-insulated panoramic sliding door is part of a comprehensive range of sustainable aluminium systems developed by Schueco to address the needs of the whole building envelope.

The range includes many types of folding- and sliding-door systems which together offer highly flexible, thermally insulated and non-insulated door solutions for use throughout the residential and commercial sectors.

When installed externally, Schueco sliding doors can accommodate almost any opening, while internally they can be employed as stylish room-dividers. However they are used, they are sure to add style with levels of thermal and acoustic performance to match.

Schüco International KG

www.schueco.com

Schüco – System solutions for windows, doors and façades

Based in Bielefeld, the Schüco Group develops and sells system solutions for windows, doors and façades. With more than 4900 employees worldwide, the company strives to be the industry leader in terms of technology and service today and in the future. In addition to innovative products for residential and commercial build-ings, the building envelope specialist offers consultation and digital solutions for all phases of a building project – from the initial idea through to design, fabrication and installation. 12,000 fabricators, developers, architects and investors around the world work together with Schüco. The company is active in more than 80 countries and achieved a turnover of 1.575 billion euros in 2017. For more information, visit www.schueco.com.au

The "Schüco" and other signs are protected in Germany and various international markets. We will provide detailed information upon request.

SCHÜCO

Australian Distributor

CAPRAL

ALUMINIUM

Contact details:

Phone: 1800 ALUMINIUM 258 646

www.capral.com.au

www.schueco.com.au

P.4330/AU/10.2018/Printed in Australia
We reserve the right to make technical changes and to correct errors. Products may differ from illustrations.